

ENGINE ROTATION

Engine rotation is viewed from the flywheel of the engine, counter clockwise would be left hand, & clockwise would be right hand



If your FLYWHEEL turns counter clockwise you have LEFT HAND engine rotation



If your FLYWHEEL turns clockwise you have RIGHT HAND engine rotation

If you can not view the engine from the flywheel end, look at the belts & pulleys and refer to the diagram below, propeller rotation is not a good indication of engine rotation, a drive or transmission can reverse engine rotation, ALL I/O ENGINES ARE LEFT HAND!



If your BELTS & PULLEYS turn clockwise you have LEFT HAND engine rotation



If your BELTS & PULLEYS turn counter clockwise you have right hand engine rotation

New GM V-8 Vortec Base Engine 5.7L, 300 HP

For Sterndrive applications only.

For those who want to upgrade, and want more power!!! These 5.7 L engines are new, not remanufactured, and come equipped with: Carburetor, electronic ignition, all tin (Valve Covers, Oil Pan and Timing Chain Cover), Electronic Fuel Pump and Pressure Switch, Harmonic Balancer, Circ. Pump, Spark Plugs, Wires & Flywheel.



Displacement: 5.7L / 350 C.I.D.
 Cylinders: V-8
 Bore & Stroke: 4.00 x 3.48
 Comp. Ratio: 9.4 : 1 High Flow Vortec Heads
 Block Mfg.: GM Powertrain
 Fuel System: Holley 4159/4bbl
 Ignition: Electronic, Delco HEI
 Fuel Required: Unleaded, 89 Octane Min.
 WOT RPM Range: 4400-4800
 Oil Type: SAE 15W40 Penzoil Marine
 Warranty: 12 Month Limited

Part# BAR350-BASE

New 3.0 L GM Service Replacement Engines



Displacement: 3.0L / 181 C.I.D.
 Cylinders: In-Line 4 Cylinder
 Bore & Stroke: 4.00 x 3.30
 Comp. Ratio: 9.25 : 1 High Flow Vortec H
 Block Mfg.: GM Powertrain
 Fuel Required: Unleaded, 89 Octane Min.
 Horsepower: 140 hp @ 4800 rpm (Carb.)
 Oil Type: SAE 15W40 Pennzoil Marine
 Warranty: 12 Month Limited

Part# BAR-3.0L

New 4.3 L GM Service Replacement Engines



Displacement: 4.3L / 229 C.I.D.
 Cylinders: V-6
 Bore & Stroke: 4.00 x 3.48 Inches
 Comp. Ratio: 9.4 : 1
 Block Mfg.: GM Powertrain
 Fuel Required: Unleaded, 89 Octane Min.
 Horsepower: 223 hp @ 4800 rpm (Carb.)
 Oil Capacity: 4.5 QT
 Warranty: 12 Month Limited

Part# BAR-4.3L

New 5.8 L Ford Service Replacement Engines



Displacement: 5.8L / 351 Cubic In.
 Cylinders: V-8
 Bore & Stroke: 4.00 x 3.50
 Comp. Ratio: 8.3 : 1
 Block Mfg.: Ford
 Cylinder Heads: H.O. (GT-40 Heads)
 Fuel Required: Unleaded, 89 Octane Min.
 WOT RPM Range: 4200-4400 RPM
 Oil Type: SAE 15W40 Pennzoil Marine
 Warranty: 12 Month Limited

Part# BAR351-FORD

REMANUFACTURED GM 5.7L V8 VORTEC LONG BLOCKS

(includes valve covers, timing cover and oil pan) also includes engine water circulating pump and harmonic balancer. (DOES NOT include intake manifold) NOTE VORTEC uses 8-BOLT INTAKE MANIFOLD



Part#
BAR021039-1030
BAR031039-1030

Description:
Standard rotation (LH)
for sterndrives
Opposite rotation (RH)
for inboards

MARINE ENGINES

REMANUFACTURED LONG BLOCKS

REMANUFACTURED LONG BLOCKS

FIRST MATE



- 2 Year Limited Warranty*
- New Pistons and Moly Rings
- Marine Cam and Lifters
- Brass Freeze out Plugs
- New Rod, Main and Cam Bearings
- New Heavy Duty Timing Chain and Gears
- New Oil Pump
- New Fel-Pro Gasket Set
- Block Resurfaced Bored and Honed
- Crank shaft Reconditioned
- Connecting Rods Reconditioned
- Valve Guides Reconditioned
- Heads Resurfaced
- New Valve Springs
- Three Angle Valve Job
- Spin Tested

- **FIRCR-318-LA** 318 LONG BLOCK STD. ROT.
- **FIRCR-318-RA** 318 LONG BLOCK OPP. ROT.
- **FIRCR-360-LA** 360 LONG BLOCK STD. ROT.
- **FIRCR-360-RA** 360 LONG BLOCK OPP. ROT.
- **FIRGM-262-LA** 4.3LV-6 2 PIECE MAIN SEAL
- **FIRGM-262-LH** 4.3L V-6 1 PIECE MAIN SEAL

- **FIRGM-350-LAF** 350 2 PIECE SEAL PRE-1986 STD. ROT.
- **FIRGM-350-RAF** 350 2 PIECE SEAL PRE-1986 OPP. ROT.
- **FIRGM-350-LBF** 350 ONE PIECE REAR MAIN SEAL
- **FIRGM-350-LCF** 350 1 PIECE SEAL 1987 & UP STD. ROT.
- **FIRGM-350-RCF** 350 1 PIECE SEAL 1987 & UP OPP. ROT.
- **FIRGM-454-LA** 454 GEN IV, MECH FUEL PUMP STD. ROT.
- **FIRGM-454-RA** 454 GEN IV, MECH FUEL PUMP OPP. ROT.
- **FIRME-224-LA** 224 LONG BLOCK STD. ROT.

* First year all parts are covered and labor up to \$450.00

* Second year all parts are covered, no labor reimbursement

MOELLER[®]
marine products

- Tanks
- Fuel Filters
- Primer Bulbs
- Fuel Line Assemblies
- Fuel Line Connectors
- Fuel Senders / Gauges
- Marine Spray Paints
- Motor Flushers
- & much more!

Fluid Transfer Technology
Engineered Specifically for the Recreational Boating Industry

©2005 Moller Marine Inc., All Rights Reserved.

Intake Manifold SB GM Pre-1986

Blue Jacket
A Division of **Blue Jay**



Part#

BJM72646T

Description:

Fits GM small block V-8 engines prior to 1986 with 12 bolt mounting pattern. (pre-vortec), valve covers bolt around rim

Intake Manifold GM SB Hi-Rise



Part#

856076

Description:

Fits GM SB (5.7L, 5.0L) engines with 12 bolt mounting pattern, (pre vortec) valve covers bolt down center

Intake Manifold GM 454 7.4L (Oval Ports)



Part#

38541009

Description:

Fits all 454 7.4L GM engines with oval ports and 4 BBL rochester carburetors. 16 bolt mounting

Intake Manifold Vortec G.M. Small Block

Blue Jacket
A Division of **Blue Jay**



Part#

BJM14097499

Description:

4BBL intake manifolds for the new style small block GM vortec engines, cast iron with an eight bolt pattern. This manifold has no attachment for the choke spring mechanism, so a carburetor with electronic choke is required, 8 bolt mounting

Intake Manifold Bolt Kit SB GM V-8



Part#

PNR854010

Description:

Fits small block GM V8,V6 engines. 12 bolt or 8 bolt intake applications, stainless steel 16 point bolts for better grip. 4.3L, 5.0L, 5.7L.

PIONEER Inc

Intake Manifold Bolt Kit GM BB V-8



Part#

PNR854011

Description:

Stainless steel 16 point bolts for all big block GM intake manifolds. 7.4L GM

MARINE ENGINES

CYLINDER HEADS

Rebuilt Head

Inline 6 cylinder
250 cu. in. GM

Part# FIRH-6007



Rebuilt Head

3.7 liter Mercruiser 470/485
aluminum block engines

Part# FIRH-6051



Rebuilt Head

4.3 liter V-6 GM without
balanced shaft

Part# FIRH-6009



Rebuilt Head

5.0 liter 305 cu. in. GM early
style valve cover bolt around rim

Part# FIRH-6015



Rebuilt Head

5.0 liter 305 cu. in. GM, Late
style valve cover with bolt
down center.

Part# FIRH-6017

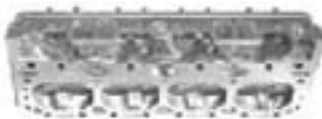

Rebuilt Head

5.7 liter 350 cu. in. GM early
style valve cover bolt around rim

Part# FIRH-6024 (882-Casting)
Part# FIRH-6022-Most Applications



Rebuilt Head

5.7 liter 350 cu.in. GM, late
style valve cover bolt down
center

Part# FIRH-6023



New Take Off Head

5.7 liter 350 cu. in. GM Vortec
Valve cover bolt down center

Part# BJM1640



Rebuilt Head

7.4 liter 454 cu.in. GM, Gen. IV
Part# FIRH-6031 SM-oval ports
Part# FIRH-6032 LG oval ports



Rebuilt Head

7.4 liter 454 cu.in. GM
Large oval intake ports Gen V
Part# FIRH-6033



Rebuilt Head

318 cu. in V-8 Chrysler
Part# FIRH-6041A



Rebuilt Head

360 cu. in. V-8 Chrysler
Part# FIRH-6045A



NOTE: Call our sales dept. for instructions on locating your casting number to insure correct replacement is ordered

TIMING CASE COVERS

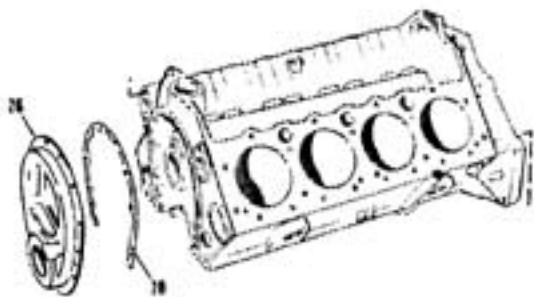

| Part # | Description |
|-----------|---|
| BJM59341 | In line 4 and 6 Cyl. GM Timing Chain Cover, No Gasket |
| 18-0887 | Cover Gasket for In line 4 and 6 cylinder |
| BJM6544-K | V-6 and V-8 Small Block GM Timing Chain Cover Kit with Cover Gasket & Bi-Rotational timing seal |
| 18-0976 | Cover Gasket For BJM6544-K (included with cover) |
| 914870 | V-8 GM-Big Block Timing Chain Cover, No Gasket |
| 18-0980 | Cover gasket - Big Block GM Timing Cover |
| 3853195 | Timing Pointer for V-6 & V-8 Small Block GM |
| 59966 | Timing Pointer for V-8 Big Block, LH Rotation Engines |
| 2697335 | Front Seal, V-6 & V-8 Small Block GM, Bi-Rotational |
| 268219471 | Front Seal, V-8 Big Block GM, Bi-Rotational |
| PNRS-1105 | Timing Cover Bolt Kit, All GM V-6 & V-8 |

Valve Cover Kit SB GM

Valve Cover Kit fits 1987 and later GM Small Block V8, Bolts down center. Kit Includes Valve Covers Rubber Gaskets and all hardware

Part# BAR55-6000



Oil Filler Cap

Fits GM 1987-up Valve Cover, Screw in Plastic (will not rust)

Part# 3854008



Valve Cover 4.3L

1986 & Up

Valve cover fits GM 4.3L V6, 1986 & up

Part# 3854949 Port Side

Part# 3854948 Starboard Side



Grommets

| Part # | Description |
|------------|-------------------------------|
| 2552188 | Grommet, Small Block GM |
| 2559987 | Grommet, Big Block GM |
| 47957 | Connector, straight |
| CRU1104594 | Connector, 45° |
| R035015 | PCV valve, 90° 3/8" hose |
| EEMFV156DP | PCV valve, straight 1/2" Hose |
| EEMFV181DP | PCV Valve, Straight 3/8" Hose |

Oil Cap Early Style

Oil Cap, Twist in type for 1.25" Dia. hole

Part# 17345



Oil Cap Push In "Blank"

Oil Cap, push in style for 1.25" diameter hole

Part# BJM6539



Valve Cover Center Bolt

2 Hole

For GM small block V8 1986 & up, steel

Part# 3856928 (each)



Valve Cover Before 85

Valve cover fits GM small block V8, prior to 1985. Bolts around the rim

Part# BJM6541 (Pair)



Valve Cover Big Block

Prior to Gen V

454 Cu. In. 7.4 liter GM

Part# 822305T (Pair)

Head Bolt Kits- 2 Heads

| Part # | Description |
|-----------|--------------------|
| PNR851200 | Small Block GM V-8 |
| PNR851201 | Big Block GM V-8 |
| PNR851202 | Ford 302/351 V-8 |

Intake Manifold Bolt Kits

| Part # | Description |
|-----------|--------------------|
| PNR854010 | Small Block GM V-8 |
| PNR854011 | Big Block GM V-8 |

Dowel Pin Kits

| Part # | Description |
|-----------|----------------------------|
| PNRS-1110 | Dowel Pin Kit, SB GM Chevy |
| PNRS-1111 | Dowel Pin Kit, BB GM Chevy |

MERC 470/485 FRONT COVER

| PART # | DESCRIPTION |
|---------|--|
| 18-4380 | #7,#8,#9 Gasket Kit |
| 18-0172 | #6 Camshaft seal (2) |
| 2667388 | #5 Crankshaft Seal (1) |
| FM99087 | Redi sleeves for camshaft (2 required) |

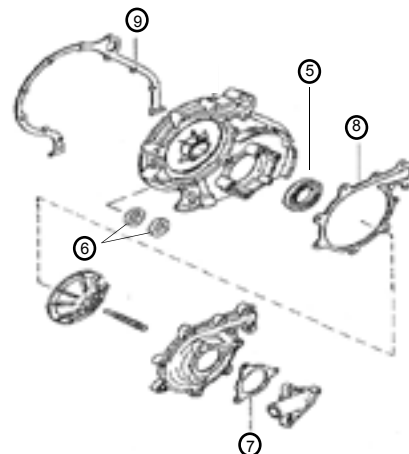

MARINE ENGINES

OIL PANS

Oil Pan 5.0 Liter Chevy

For GM small block V8 1986 & older, marine grade steel, starboard dipstick and windage tray. Two-piece rear main seal

Pan.....94130

Pan Gasket.....18-0411



Oil Pan 3.7 Merc

For Mercruiser 3.7L 224 cid 470-485 4 cylinder aluminum block engine

Pan71938A1

Pan Gasket....18-4366



Oil Pan 305/350 Old Style

For GM small block V8 up to 1979 (left dip), steel, two-piece rear main includes pan gasket

980969



Oil Pan 5.7 Liter Chevy

For GM small block V8, steel 1986 and older two-piece rear main seal, starboard dipstick and no windage tray

Pan.....984477

Pan Gasket.....18-0411



Oil Pan 5.0 & 5.7 Liter

Steel SB Chevy 1987 & newer, stbd. side dipstick, one piece rear main seal, no windage tray. (Plastic Coated)

Pan.....BJM809910

Pan Gasket..18-1237



Oil Pan 454 (350HP)

For GM big block Gen. IV, steel 1982-1987

FEL17985



Oil Pan 4.3 Liter V-6

1987 & newer, steel, one-piece rear main seal with windage tray.

Pan.....988234

Pan Gasket....FEL17971



Oil Pan 454 (7.4 liter)

For GM big blocks, stamped steel (8 Qts) 1988-1991

Pan.....19221T

Pan Gasket....FEL17985



Oil Pan 3.0 Liter

Chevy 4-Cylinder center sump (1991 and newer) One-piece rear main seal.

Pan.....3854015

Pan Gasket....278108461



TRANSMISSION & DRIVETRAIN PARTS

ENGINE COUPLERS



MERCUISER ENGINE COUPLERS



Part#
18-2171

Description:
3-1/2" Bolt circle, replaces 76850A2, for all early GM engines except MR/ALPHA/BRAVO w/ triangular 3 bolt coupler



Part#
18-2172

Description:
3" bolt circle, replaces 14505A2, use when new style block w/ 3" crank bolt circle is replacing older block w/ 3-1/2" bolt circle



Part#
18-2173

Description:
3" bolt circle, replaces 59826A3 for ford engines



Part#
18-2413

Description:
3" bolt circle, replaces 69354A2, for 470, 485 (224 cu.in.) s/n 4208730-6218036 (1976-1982)



Part#
18-2414

Description:
Replaces 97432A2 for 165, 170, 470, 3.7L s/n 6170297 & up (1983-1989) & 180, 190, 488 3.7LX s/n 6170297 & up 1983-1989)



Part#
18-2175

Description:
Replaces 18643A7, flex plate style for late model, small crankshaft bolt pattern style engines



Part#
18-2195

Description:
Replaces 12632A7, flex plate style for GM 4 cyl. engines w/ late style, small crankshaft bolt pattern



Part#
18-2323

Description:
Replaces 18643A5, flex plate style for late model, small crankshaft bolt pattern style engines w/ out yoke



Part#
18-2321

Description:
Replaces 12632A7, flex plate style for GM 4 cyl. engines w/ late style, small crankshaft bolt pattern w/ no yoke



Part#
18-2412

Description:
Replaces 18311A17, 861523A9, for BRAVO

TRANSMISSION & DRIVE CHAIN PARTS

DRIVE PLATES



Part#

BJMDA101

Description:

Full circle 13.87" dia. for 26 spline transmissions, use on CAT 3208's & Detroit Diesel 6-71's



Part#

BJMDA102

Description:

6.18" dia. damper for 26 spline transmissions as used on flywheel forward Flagship, Chris Craft, & Perkins



Part#

BJMDA106

Description:

3 Legged damper for 26 spline transmissions & flywheel dia. above 13.32", for V8 engines up to 350 cu.in., Chrysler LM 318/360, use upto 260 hp, damper for 14" flywheels



Part#

BJMDA106A

Description:

3 Legged damper for 26 spline transmissions & flywheel dia. less than 13.32", for V8 engines up to 350 cu.in., Chrysler LM 318/360, use upto 260 hp, damper for 12-3/4" flywheels



Part#

BJMDA107

Description:

Full circle damper, use on GM 454 cu.in. 7.4L & Chrysler 440's 13.25" dia. for 26 spline transmission, for engines up to 350 HP, 14" flywheels



Part#

BJMDA108

Description:

Full circle 14" flywheels, use on small blocks from 275 to 325 hp



Part#

BJMDA111

Description:

Full circle 14" flywheels, use on 454 (375 to 500 hp) high performance



Part#

AS3-K2C

Description:

Heavy duty damper for diesel applications, up to 15" dia. for 26 spline transmission



Part#

R140001

Description:

Small Block Ford damper is a 3 legged original equipment damper for the larger 14" Flywheels. Fits the standard 26 spline transmission.

TRANSMISSION & DRIVETRAIN PARTS

BORG WARNER VELVET DRIVE TRANSMISSION

71C & 72C Transmission Assembly - Current Production

| Item# | Part# | Description |
|-------|---------------|--|
| 1 | ALT23321 | Nut, coupling early production 1 1/2 hex head |
| 1 | 1000-149-034 | Nut, coupling late production 1 11/16 hex head w/washer |
| 2 | ALT23323 | Flange coupling 5" 10 spline w/small seal BW# 4547AY |
| 2 | ALT23324 | Flange coupling 4" 10 spline w/small seal BW# 454-7BA |
| 2 | ALT23327 | Flange coupling 5" 24 spline w/large seal SW# 1000-31 -001 |
| 2 | 4912 | Flange coupling 5" 24 spline w/small seal |
| 3 | 71-7 | Bearing retainer (10-17) |
| 6 | ALT23421 | Rear seal small (old style) (7/8" Nut) |
| 6 | ALT23422 | Rear seal big (new style) (1-1/8" Nut) |
| 8 | ALT23025 | Gasket (10-17) |
| 8 | ALT23026 | Gasket (10-18) |
| 17 | 10-17-559-001 | Dipstick (Direct Drive), 1017/1018/71C/72C 1:1 |
| 17 | 10-04-559-001 | Dipstick (Reduction), 1017/1018/71C/72C Reduction |
| 17 | 10-06-559-001 | Dipstick (V-Drive), |
| 24 | 71-42 | Spring |
| 25 | 1004-420-052 | Complete neutral switch kit |
| 26 | ALT99328 | Neutral safety switch small 7/8" nut size (new style) |
| 26 | 71-A102 | Neutral safety switch large 1-1/8" nut size (old style) |
| 27 | 10-00-141-046 | O Ring |
| 32 | ALT23022 | Gasket |
| 33 | 71-A244A | Control Valve |
| 34 | 4821 | Snap Ring |
| 40 | ALT23350A | Pump Assy. |
| 42 | ALT23420 | Front Seal |
| 43 | ALT23002 | Pump Gasket |
| 49 | ALT23020 | Gasket |
| 53 | ALT1393484 | O Ring |
| 55 | ALT23739 | Steel clutch plate reverse |
| 56 | ALT23738BR | Bronze clutch plate reverse |
| 57 | ALT23276 | Spring |
| 58 | 71-87A | Pin |
| 59 | ALT23188 | Thrust Washer |
| 64 | 71-70 | Cylinder (10-17) |
| 65 | 10-16-124-001 | Piston |
| 66 | ALT1391984 | O Ring |
| 67 | ALT23054A | Seal Ring |
| 69 | ALT23767 | Spring |
| 71 | ALT23760 | Clutch Plate Steel |
| 72 | ALT23701 | Steel clutch plate forward (10-17) |
| 74 | ALT49700BR | Friction clutch plate |
| 74 | ALT23761 | Clutch Pressure Plate |
| 77 | ALT23196 | Washer |
| 86 | 71-159 | Washer |
| 86 | 10-17-193-001 | Large washer |
| 94 | 71C-A98 | Oil strainer assembly |
| 95 | ALT23331 | Breather (push in) |

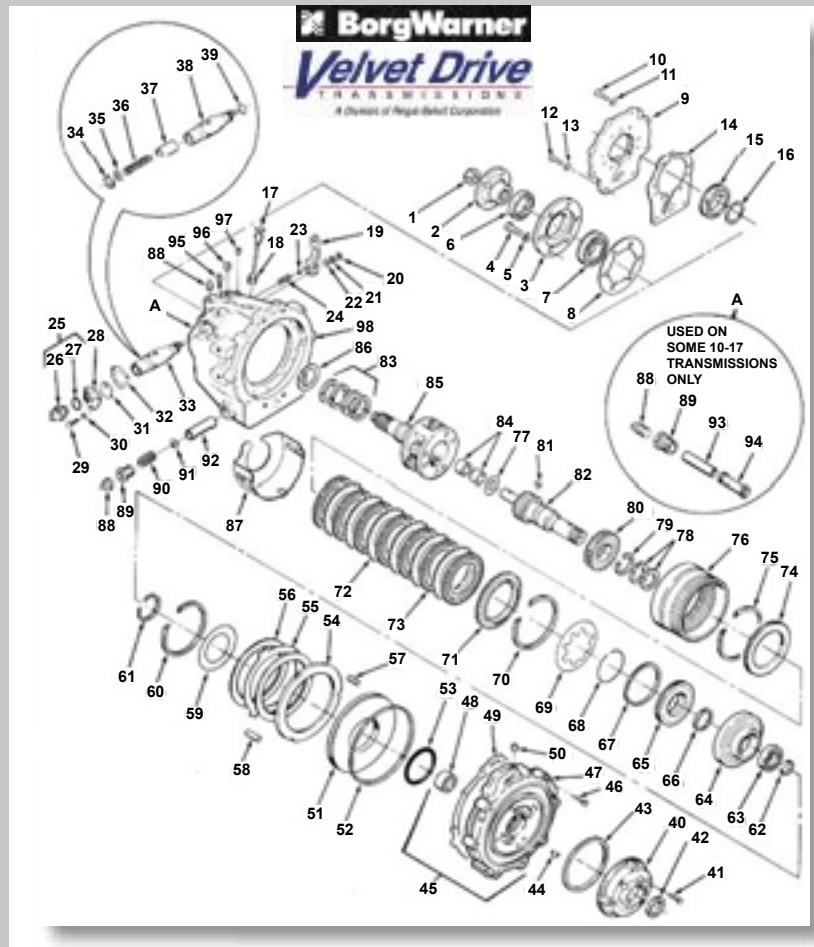

TRANSMISSION & DRIVETRAIN PARTS

TRANSMISSION PARTS & KITS

TRANSMISSION GASKET KIT



Part#
ALT23801
Description:
for 70C, 71C, 72C, 10:17 & 10:18, contains gaskets & o-rings



TRANSMISSION OVERHAUL KIT



Part#
ALT23801B
Description:
for 70C, 71C, 72C, 10:17 & 10:18, contains gaskets, o-rings, oil seals, & snap rings

TRANSMISSION MASTER OVERHAUL KIT



Part#
ALT23901
Description
for 70C, 71C, 72C, contains gaskets, o-rings, oil seals, snap rings, plus bronze & steel clutch plates

TRANSMISSION CLUTCH PACKS



Part#
ALT23755
Description:
Forward, all borg warner 71 & 10:17 series



Part#
ALT23755A
Description:
Forward, all borg warner 72 & 10:18 series



Part#
10-04-559-001 (17) Dipstick for Reduction (1017 / 1018 / 71C / 72C / Reduction)
10-06-559-001 (17) Dipstick for V-drive
10-17-559-001 (17) Dipstick for Direct Drive (1017 / 1018 / 71C / 72C / 1:1)



Part#
ALT23422 (6) Rear Seal, replaces 10-00-044-017 inner dia. 2-1/2", outer dia. 3-1/4"
ALT23421 (6) Rear Seal, replaces 71C-110 inner dia. 2", outer dia. 2-1-4"
ALT23420 (42) Front seal, replaces 10-00-044-014 inner dia. 1-1/2", outer dia 2"



Part#
71-42
Description
(24) Shift detent



Part#
1004-420-052
Description
Neutral safety kit complete, 7/8"



Part#
ALT99328
Description
(26) Neutral safety switch small new style, 7/8" nut size



Part#
71-A102
Description
(26) Neutral safety switch large old style, 1-1/8" nut size

TRANSMISSION & DRIVETRAIN PARTS

TRANSMISSION PARTS & KITS



Part#
71-A244A **Description**
(33) Control valve



Part#
ALT23350A **Description**
(40) Oil pump assembly



Part#
ALT23331 **Description**
(95) Breather (push in)



Part#
ALT23323 **Description**
(2) Flange coupling 5" 10 spline
w/ small seal



Part#
ALT23324 **Description**
(2) Flange coupling 4" 24 spline
w/ large seal



Part#
ALT23327 **Description**
(2) Flange coupling 5" 24 spline
w/ small seal



Elastomer, a stiff, yet resilient material, has excellent energy absorbing properties. It will retain its design characteristics over a long period of time and will return to original shape even after being under compression.

It withstands oil, gasoline, sludge, saltwater and a temperature range of -65° to + 225°F.

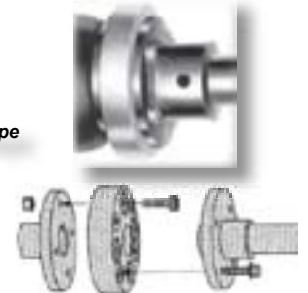

| Part# | Flange Dia. | Number of Bolts | Bolt Dia. | Bolt Circle | Pilot Dia. | Coupling Dia. | Coupling Thickness | Pkg. Wt. | Torque Rating | "Plus Rated" |
|----------|-------------|-----------------|-----------|-------------|------------|---------------|--------------------|----------|---------------|--------------|
| GLO404A | 4 | 4 | 3/8 | 3-1/4 | 2-1/2 | 5 | 1 | 1-3/4 | 550 | |
| GLO404AC | 4 | 4 | 3/8 | 3-1/4 | 2-5/8 | 5 | 1 | 1-3/4 | 550 | |
| GLO404V | 4 | 4 | 10mm | 8cm | 6cm | 5 | 1 | 1-3/4 | 550 | |
| GLO424Y | 100mm | 4 | 10mm | 78mm | 50mm | 4-1/4 | 1 | 1-3/4 | 550 | |
| GLO454 | 4-1/2 | 4 | 3/8 | 3-3/4 | 2-5/8 | 5-3/8 | 1 | 2-1/4 | 570 | |
| GLO504 | 5 | 4 | 3/8 | 4-1/4 | 2-1/2 | 6 | 1 | 2-1/2 | 675 | 1800 |
| GLO504A | 5 | 4 | 7/16 | 4-1/8 | 2-3/4 | 6 | 1 | 2-1/2 | 675 | |
| GLO5756 | 5-3/4 | 6 | 1/2 | 4-3/4 | 3 | 6-13/18 | 1-1/8 | 4-1/4 | 1800 | 3000 |

TRANSMISSION & DRIVETRAIN PARTS

STANDARD & SPLIT SHAFT COUPLINGS



STANDARD SHAFT COUPLERS WITH 2-1/2" PILOT

| Bore size | 4" Flange | 5" Flange |
|-----------|---------------|---------------|
| 3/4" | BUC50MC004075 | |
| 7/8" | BUC50MC004087 | |
| 1" | BUC50MC004100 | BUC50MC005100 |
| 1-1/8" | BUC50MC004112 | BUC50MC005112 |
| 1-1/4" | BUC50MC004125 | BUC50MC005125 |
| 1-3/8" | BUC50MC004137 | BUC50MC005137 |
| 1-1/2" | BUC50MC004150 | BUC50MC005150 |
| 1-3/4" | | BUC50MC005175 |
| 2" | | BUC50MC005200 |



| Part# | Description |
|----------------|----------------|
| BUCSETSCREW375 | 3/8" x 1-1/8" |
| BUCSETSCREW431 | 7/16" x 1-1/2" |

SPLIT SHAFT COUPLERS WITH 2-1/2" PILOT

| Bore size | 4" Flange | 5" Flange |
|-----------|---------------|---------------|
| 1" | BUC50400B1000 | |
| 1-1/8" | BUC50400B1125 | |
| 1-1/4" | BUC50400B1250 | BUC50500A1250 |
| 1-3/8" | BUC50400B1375 | BUC50500B1375 |
| 1-1/2" | BUC50400B1500 | BUC50500B1500 |



MARINE BEARINGS



All Bearings are engineered to meet specifications set forth by the American Bureau of Shipping and The U.S. Navy (MIL-B-17901A CLII). Bearings are designed to withstand the brutal service demands encountered in the corrosive marine and industrial environments. The fluted rubber bearing surface resists excessive abrasion and is more wear-resistant than hard surface bearings by as much as 10 times.

These bearings will function in any water-based liquid including most petro and chemical products. Operating temperatures range from +39 to 158°F (+4 to 70°C). Normal bearing loading capacity up to 35 psi, (.0246 kg. per sq. mm.). The shaft is cushioned by a continuous flow of 2 gals/min (7.5 liters/25 mm. of shaft diameter/min.) through the bearing.

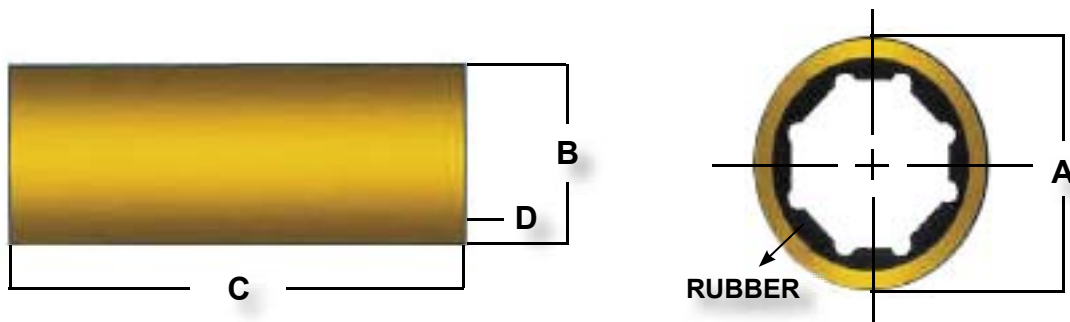

| Part# | Shaft Dia. A | Outside Dia. B | Length C | Metal Wall D |
|--------------|-----------------|-------------------|-------------|-----------------|
| MORALBACORE | 3/4" | 1 1/4" | 3" | 1/8" |
| MORBLENNY | 7/8 | 1 1/4 | 3 1/2 | 1/16 |
| MORBARRACUDA | 7/8 | 1 3/8 | 3 1/2 | 1/8 |
| MORBASS | 7/8 | 1 1/2 | 3 1/2 | 1/8 |
| MORBLACKFISH | 1 | 1 1/4 | 4 | 1/32 |
| MORBLOATER | 1 | 1 3/8 | 4 | 1/16 |
| MORBONITO | 1 | 1 1/2 | 4 | 1/8 |
| MORBROADBILL | 1 | 1 5/8 | 4 | 1/8 |
| MORBULLHEAD | 1 | 2 | 4 | 1/8 |
| MORCAMA | 1 1/8 | 1 1/2 | 4 1/2 | 1/16 |
| MORCARP | 1 1/8 | 1 5/8 | 4 1/2 | 1/8 |
| MORCATFISH | 1 1/8 | 1 3/4 | 4 1/2 | 1/8 |
| MORCHOGSET | 1 1/4 | 1 1/2 | 5 | 1/8 |
| MORCHUB | 1 1/4 | 1 3/4 | 5 | 1/8 |
| MORCOD | 1 1/4 | 2 | 5 | 1/8 |
| MORCROAKER | 1 1/4 | 2 1/8 | 5 | 1/8 |
| MORDEVILFISH | 1 3/8 | 1 7/8 | 5 1/2 | 1/8 |
| MORDOGFISH | 1 3/8 | 2 | 5 1/2 | 1/8 |
| MORDOLPHIN | 1 3/8 | 2 1/8 | 5 1/2 | 1/8 |
| MOREEL | 1 3/8 | 2 3/8 | 5 1/2 | 1/8 |
| MORFLATFISH | 1 1/2 | 2 | 6 | 1/8 |
| MORFLOUNDER | 1 1/2 | 2 3/8 | 6 | 1/8 |
| MORGROUPER | 1 3/4 | 2 3/8 | 7 | 1/8 |
| MORHADD0 | 1 3/4 | 2 5/8 | 7 | 1/8 |
| MORHERRING | 2 | 2 5/8 | 8 | 1/8 |
| MORKINGFISH | 2 | 3 | 8 | 1/8 |

TRANSMISSION & ENGINE ACCESSORIES

REMOTE OIL FILTER BRACKETS

SEPARATE FLYWHEELS & RING GEARS



| Part # | Description |
|-------------|--|
| 4397433A1 | Ford 302/351 Ring Gear Only (157 teeth) |
| E7770M | LM 318/360 Ring Gear Only (160 teeth) |
| PNRFRG-153B | Chevy Block ring gear w/12-1/2" diameter flywheel (153 Teeth) |
| PNRFRG-168S | Chevy Block ring gear w/14" diameter flywheel (168 teeth) |
| IND55-1043 | Small Block GM Flywheel w/14" diameter, I/O's only 3" bolt pattern |
| 984718 | Small Block GM Flywheel w/ 12-1/2" diameter, 3" bolt pattern, I/O's only. This flywheel is used only on sterndrive repowers. Use when replacing older engines with new Vortec engine. Allows for clearance in older 12" bell housings. |
| IND55-1044 | Small block GM flywheel w/14" diameter, I/O's or Inboards, 3" bolt pattern |

Universal Remote Mount Oil Filter

MP0520-000 Adaptor: Remove existing oil filter & spin on new adaptor



MP0520-002 Replacement O-rings

FRAHPK2 Bracket: Find suitable mounting location close to engine adaptor



HASLF115 Filter

*For custom hose lengths, please call our sales counter

Crusader Remote Oil Filter Mounts

Complete Kit CRU22026

Item (2) Gasket CRU20156

Item (9) Oil Filter HASLF115

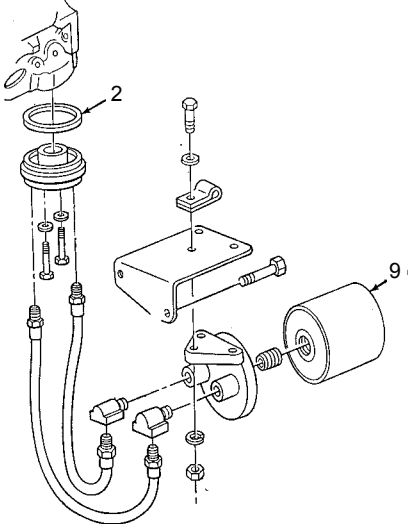

Note: We also stock all parts separate

Chrysler LM318/360 Remote Oil Filter

| Item | Part # | Description |
|------|-----------|---------------------|
| *1 | 4105210 | Gasket |
| 3 | 2847747 | Valve |
| 4 | HASLF115 | Oil Filter |
| *6 | 3671314 | Gasket |
| *7 | 2463512 | Gasket |
| *8 | 2206403 | O Ring |
| * | 4105210-K | Complete Gasket kit |

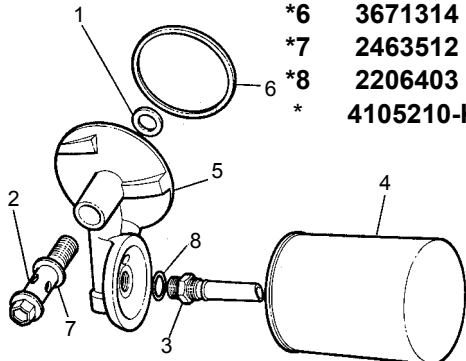

Mercury Remote Oil Filter Assembly

REMOTE OIL FILTER KITS

1043749 (2) Short Mounting Bolts

2791892 Gasket

2791892 Gasket

1044387 (2) Long Mounting Bolts

Note: When replacing stainless steel elbows, filter kit P/N 814420A5 must be used in addition to above kits.

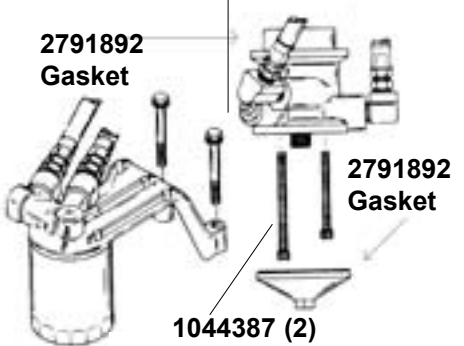

Chrysler Engine Mount

Chrysler front mount and trunnion assembly. Comes exactly as shown. Sold per mount.

4417224



Chrysler Engine Mount

Chrysler complete front mount assembly. Comes complete with front engine support as shown. Sold per mount assembly.

GR3561-3N



Engine Mount

Transmission mount for Borg Warner/Velvet drive and most other inboard trannies. Direct Replacement on most Chrysler motors and all Pleasurecraft/PCM motors.

IND53-5011



Crusader Support Bracket FRONT MOUNT

Engine support bracket for single Crusader engine mount. Accommodates CRU97926 or CRU97905 mount with 1" shaft.

CRU97938



Crusader Engine Mount - Single

Crusader single engine mount. New mount has 1" dia. shaft. *When replacing older NLA 7/8" shaft mounts, engine support bracket needs to be either drilled out or replaced.

CRU97926



Crusader Support Bracket REAR MOUNT

Engine support bracket for Crusader engine mount. Accommodates CRU97905 or CRU97926 mount with 1" shaft.

CRU97917



Crusader Engine Mount - Dual

Crusader dual engine mount. New mount has 1" dia. shaft. *When replacing older NLA 7/8" shaft mounts, engine support bracket needs to be either drilled out or replaced.

CRU97905



TRANSMISSION & ENGINE ACCESSORIES

ENGINE & TRANSMISSION MOUNTS

Engine Mount

Front engine support for most V6 & V8 GM Chevy blocks. Sold per mount and include stainless steel shaft to connect to stringer mount.

MC-8-66418@1



Engine Mount

Adjustable both Vertically and Horizontally to facilitate engine prop shaft alignment. Holds loads 200 pounds. Base is 5" x 2-3/4". 1-7/8" from bottom of mount to lowest adjustment point. 4" from bottom of mount to top of 5/8-18 stud.

BUSDF-100



Engine Mount

Adjustable both Vertically & Horizontally to facilitate engine prop shaft alignment. Holds loads up to 275 lbs. Most I/O applications use BUSDF-200 or BUSDF-216. Base is 5" x 2-3/4". 2-1/8" from bottom of mount to lowest adjustment point. 4-3/16" from bottom of mount to top of 5/8-18 stud.

BUSDF-206



Engine Mount

Adjustable both Vertically and Horizontally to facilitate engine prop shaft alignment. Holds loads UP TO 275 lbs. Most I/O applications use BUSDF-200 or BUSDF-216. Base is 5" x 2-3/4". 2-1/8" from bottom of mount to lowest adjustment point. 4-3/16" from bottom of mount to top of 3/4-18 stud. (Replaces Mercruiser # 66284A2)

BUSDF-216



Engine Mount - Diesel

Adjustable both Vertically and Horizontally to facilitate engine prop shaft alignment. Holds loads TO 550 lbs. Base is 6-1/2" x 3-3/8". 2-7/10" from bottom of mount to lowest adjustment point. 5" from bottom of mount to top of 3/4-18 stud.

BUSDF238-MI



Engine Mount - Diesel

Two Mountings in same casting. Increased capacity for Diesel and Heavy-duty applications. UP TO 650 LBS.capacity. Base is 12" x 3-3/8" wide. 2-1/2" from bottom of mount to lowest adjustment point. 4-1/2" from bottom of mount to top of 3/4-16 studs.

BUSDF-242



Engine Mount

90 Degree Base bushing mount. Each mount holds loads to 350 lbs. Base is 5" L x 1-3/4" W. Vertical flange is 1-1/2" H. 2-11/16" from bottom of mount to lowest adjustment point. 4-1/2" from bottom of mount to top of 3/4-16 stud.

8-0008



Engine Mount - Diesel

Double Bushing mount. for Diesel & Heavy-duty applications. Adjust vertically up to 1". 550 lbcapacity per mount. Base is 8-1/4" x 2" w. 3-1/8" from bottom of mount to lowest adjustment point. 5-5/8" from bottom of mount to top of 5/8-18 stud.

8-0002



TRANSMISSION & ENGINE ACCESSORIES

ENGINE MOUNTS, WEDGES, & FREEZE PLUGS

Chevy Front Mount



Front Stringer mount for most V6 & V8 GM Chevy motors. Direct replacement on all

| Item# | Part# | Description: |
|-------|------------|-------------------------|
| 1 | IND53-1004 | Mount Left (Port) |
| 1 | IND53-1005 | Mount Right (Starboard) |
| 2 | RC091001 | Front Stringer Pad |

Mercuriser Sterndrive Rear Engine Mount

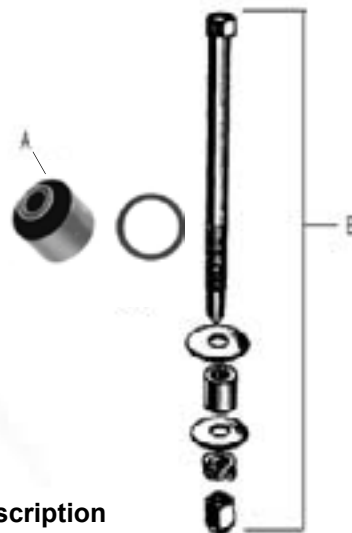

| Part # | Description |
|------------|----------------------------------|
| A- 18-2193 | Engine Mount Only |
| B- 18-2140 | Rear Mount Bolt Kit up to 1982 |
| B- 18-2141 | Rear Mount Bolt Kit 1983 & newer |

Mercuriser Engine Mount



| Item# | Part# | Description: |
|-------|-----------|--------------|
| 1 | 1466658 | Tab Washer |
| 2 | BUSDF-216 | Mount |

Brass Freeze Plug Kits

| Part # | Description |
|-------------|-----------------------|
| PNRPE-100-B |V6 & V-8 SB GM |
| PNRPE-102-B |Big Block GM |
| PNRPE-104-B |4 & 6 Inline GM |
| PNRPE-108-B |Ford 302/351 |
| PNRPE-113-B |318/360 Chrysler |
| PNRPE-114-B |440 Chrysler |
| PNRPE-125-B |Ford 460 |



MOTOR LEVELING WEDGES



Part #
BUC33MW1

Overall Diameter 1 5/8" X 4 3/4"
Bolt Slot Dimensions 9/16" x 3 7/8"



Part #
BUC33MW2
BUC33MW3

Slope Diameter 1/16" TO 1/2"
Overall Dimensions 10" x 2 1/2"
Bolt Slot Dimensions 8" x 5/8"
6 1/2" X 1 1/4"